

Końcówka szybkozłączki TYP26 1/4 GW





| | |
|---------------|------------|
| model | SZ-M26-02W |
| producent | Rectus |
| seria rectus | 26 |
| przyłącze | G 1/4 |
| DN | 7,2 |
| rodzaj gwintu | wewnętrzny |

typ szybkozłączki: TYP26 NW 7,2

gwint: wewnętrzny

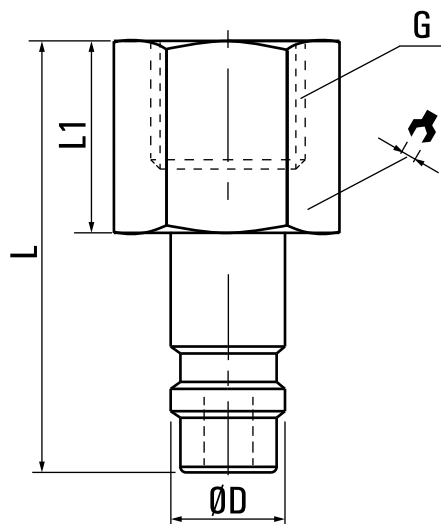
przyłącze: 1/4



| MODEL | G | ØD | L | L1 |  |
|---------|------|------|----|----|---|
| M26-01W | 1/8" | 11.9 | 31 | 8 | 14 |
| M26-02W | 1/4" | 11.9 | 32 | 9 | 17 |
| M26-03W | 3/8" | 11.9 | 32 | 9 | 19 |
| M26-04W | 1/2" | 11.9 | 34 | 11 | 24 |