

Siłownik pneumatyczny 016 X 160



Przyłącze: M5
Skok siłownika: 160 mm
Średnica tłoka: 16 mm
Działanie: dwustronne

PNEUMATIG

| | |
|-------------------|-----------------------|
| model | C-M-016-0160 |
| producent | Pneumatig |
| średnica tłoka | 16 mm |
| skok siłownika | 160 mm |
| przyłącze | M5 |
| działanie | dwustronne |
| zakres ciśnienia | 1 - 10 bar |
| zakres temperatur | -10 - 70 °C |
| korpus | stal nierdzewna |
| pokrywy | aluminium anodyzowane |
| tłoczek | stal chromowana |
| uszczelnienia | poliuretan + NBR |
| amortyzacja | mechaniczna |

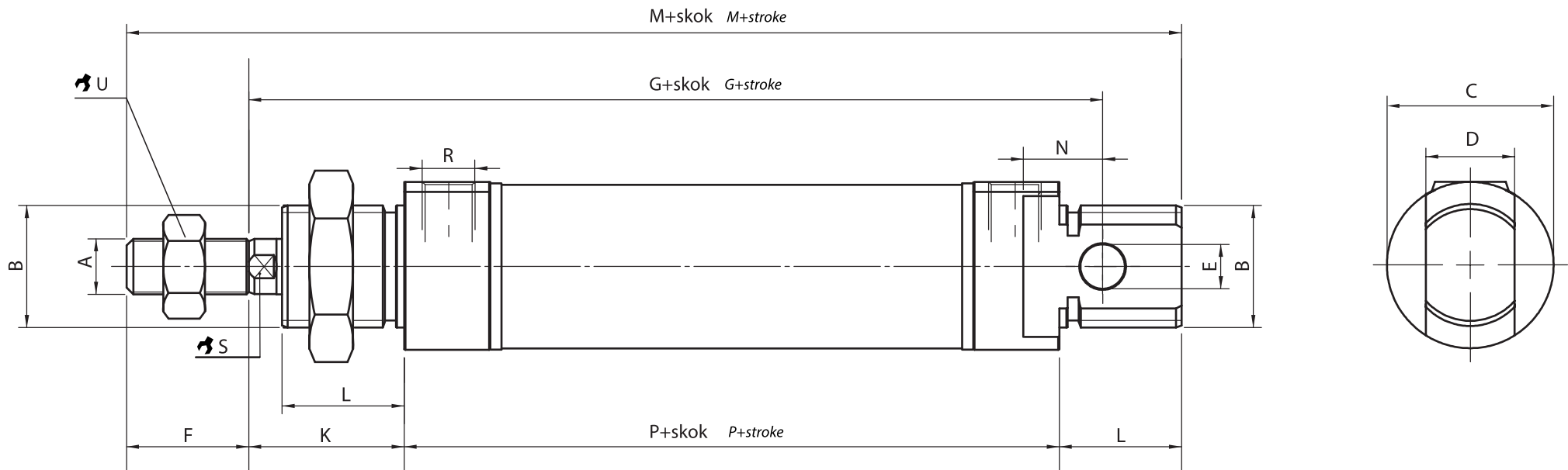

| ∅ | A | B | C | D | E | F | G | K | L | M | N | P | R | S | U |
|------|----------|----------|-----|----|----|----|-----|----|----|-----|----|----|-------|---|----|
| 8mm | M4 | M12x1.25 | ∅15 | 8 | ∅4 | 12 | 64 | 16 | 12 | 86 | 6 | 46 | M5 | - | 7 |
| 10mm | M4 | M12x1.25 | ∅15 | 8 | ∅4 | 12 | 64 | 16 | 12 | 86 | 6 | 46 | M5 | - | 7 |
| 12mm | M6 | M16x1.5 | ∅20 | 12 | ∅6 | 16 | 75 | 22 | 17 | 105 | 9 | 50 | M5 | 5 | 10 |
| 16mm | M6 | M16x1.5 | ∅20 | 12 | ∅6 | 16 | 82 | 22 | 17 | 111 | 9 | 56 | M5 | 5 | 10 |
| 20mm | M8 | M22x1.5 | ∅27 | 16 | ∅8 | 18 | 98 | 28 | 20 | 133 | 12 | 67 | G1/8" | 6 | 13 |
| 25mm | M10x1.25 | M22x1.5 | ∅27 | 16 | ∅8 | 20 | 104 | 28 | 22 | 140 | 12 | 70 | G1/8" | 8 | 17 |